

Block Party

Purpose

A Block Party is for residential neighborhoods only. The City requires an encroachment permit to ensure that the proposed street closure will not inhibit reasonable traffic flow and emergency access in the area.

Approvals

- All residents and business owners within the closed area must approve of the closure.
- Permit Center
- Fire Department
- Police Department

Fees

No Fee Permit

Plan Submittal Requirements

- Completed Application
- Names, Addresses and Signatures of surrounding neighbors
- A map of the street showing (*see attached sample*)
 - Homes and businesses occupying the street affected by the proposed closure
 - Proposed placement of the barricades and signs

Review Time

The review time is 2 weeks.

Conditions of Approval

1. The permit is valid for specified hours only, unless the City Engineer grants special approval.

2. All residents or business owners within the closed area shall be notified, and shall approve of the closure, in advance of the event. The applicant shall submit the name, signature and address of all affected residents or business owners on the attached application before a permit is issued.

3. The Police and Fire Departments must give their approval in advance of the event. (*The Permit Center completes this notification*).

4. A 12-foot wide clear zone extending the entire length of the closed street shall remain clear of all fixed objects such as vehicles, tables, chairs, lawn furniture, booths, barbecues, basketball hoops, etc. These areas will provide access for emergency vehicles and a safety buffer. Also, a clear buffer area of 20 feet shall be left between the above-mentioned objects and barricades.

5. The barricades used to close the street shall be a Caltrans type I, II, or III "A"-frame barricade with reflective panels of alternating white and orange diagonal stripes on each face. (*The barricades are available for rent at most local rental service stores*). The barricades shall be positioned not more than eight feet apart. Each end of the closed portion of road shall be barricaded. An outlet area at each end of the closure shall remain open. The applicant shall submit a sketch showing the proposed barricade placement. (*See attached for sample and second page of application for diagram space*).



6. A Caltrans standard sign shall be posted at each end of the closure, which reads, "Road Closed" Caltrans designation: R11-2, black lettering on white background. The signs are available for rent at most local rental service stores.
7. No litter or debris shall be left on the street after the event is over. The street shall be clean and free of obstructions before it is again opened for vehicle traffic.
8. The permit may be revoked if the City observes a hazardous condition or nuisance to the public during the event.
9. The applicant shall protect, defend and indemnify the City of Livermore, its officers, agents, employees, and volunteers and hold them harmless in every way from all action at law for damage or injury to persons or property that may arise out of or be occasioned in any way or by the block party including preparation or dismantling.
10. The City of Livermore does not allow fireworks.

Additional Resources



STREET CLOSURE FOR BLOCK PARTY APPLICATION

Please print or type the following information:

Applicant's Name: _____

Applicant's Address: _____

Applicant's Phone No: _____ Email Address: _____

Date(s) of Block Party: _____ Type of Party: _____ -

Street(s) to be Closed: From (Street Address) _____ Anticipated attendance: _____

_____ To (Street Address) _____

Time when closure will be in effect (See Condition of Approval #1):

From: _____ (am/pm) To: _____ (am/pm)

I certify that all Special Conditions will be strictly adhered to:

Applicant's Signature

-FOR OFFICE USE ONLY-

Reviewed and approved by:

Police Department Representative

Fire Department Representative

Please obtain the signatures of all residents or business owners within the closed area:

We, the undersigned, hereby agree to the temporary street closure for a block party proposed by the applicant. *(Each affected resident or business owner must sign before the permit can be issued).*

Printed Name Signature Address

Printed Name Signature Address

City Hall

Community Development Department
1052 South Livermore Avenue
Livermore, CA 94550

phone: (925) 960-4440
fax: (925) 960-4419
TDD: (925) 960-4104

www.cityoflivermore.nt

Printed Name	Signature	Address
Printed Name	Signature	Address
Printed Name	Signature	Address
Printed Name	Signature	Address
Printed Name	Signature	Address
Printed Name	Signature	Address
Printed Name	Signature	Address
Printed Name	Signature	Address

(If more spaces are required, please photocopy this page)

Below is a space provided for your drawing. Please show the following items:

- 1) Map of the street
- 2) Street address
- 3) Barricade locations
- 4) Sign locations

(See sample on handout)

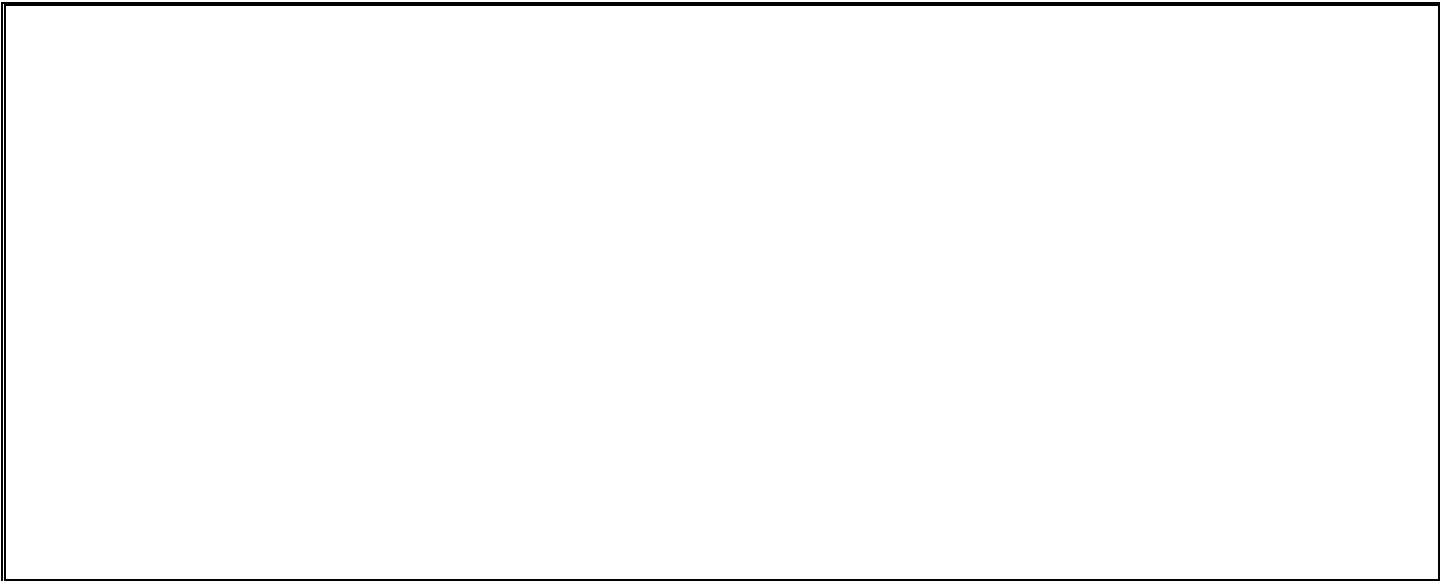

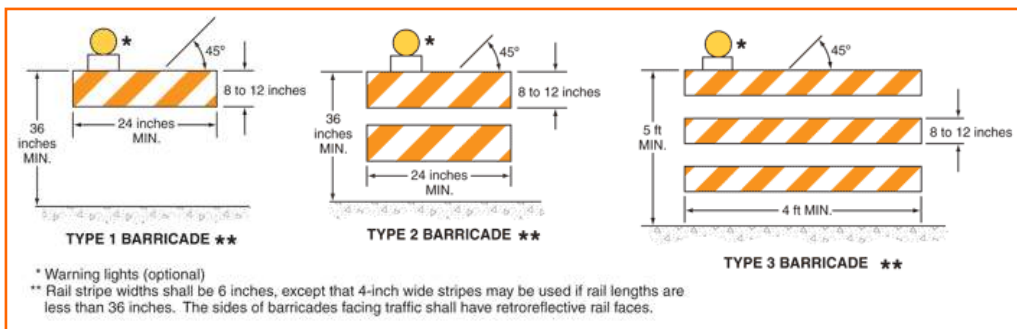

R11-2 SIGN

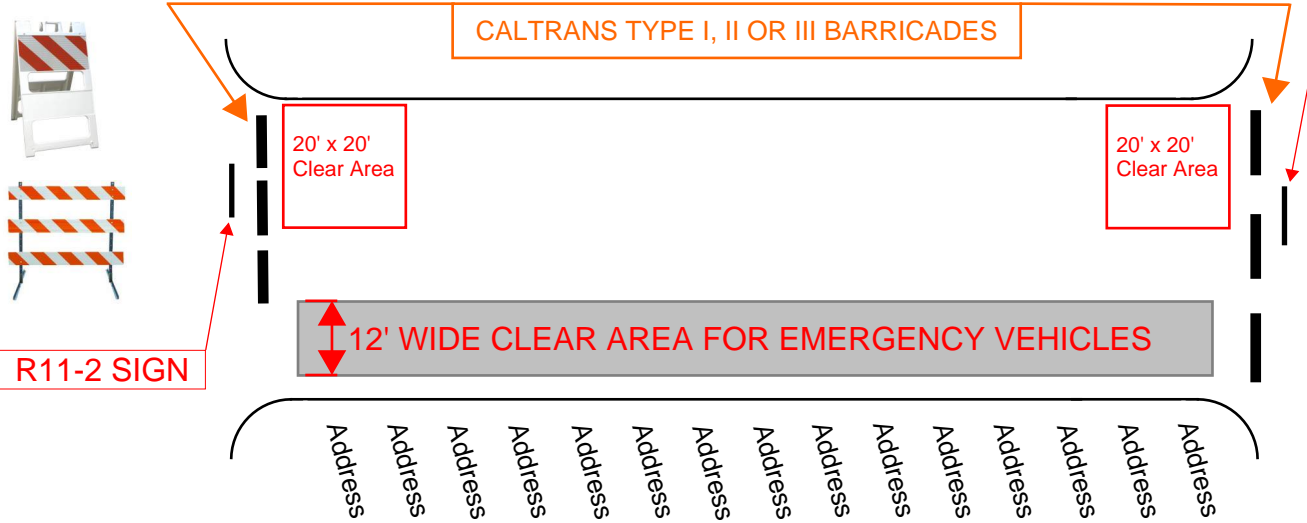

TYPICAL MID-BLOCK CLOSURE

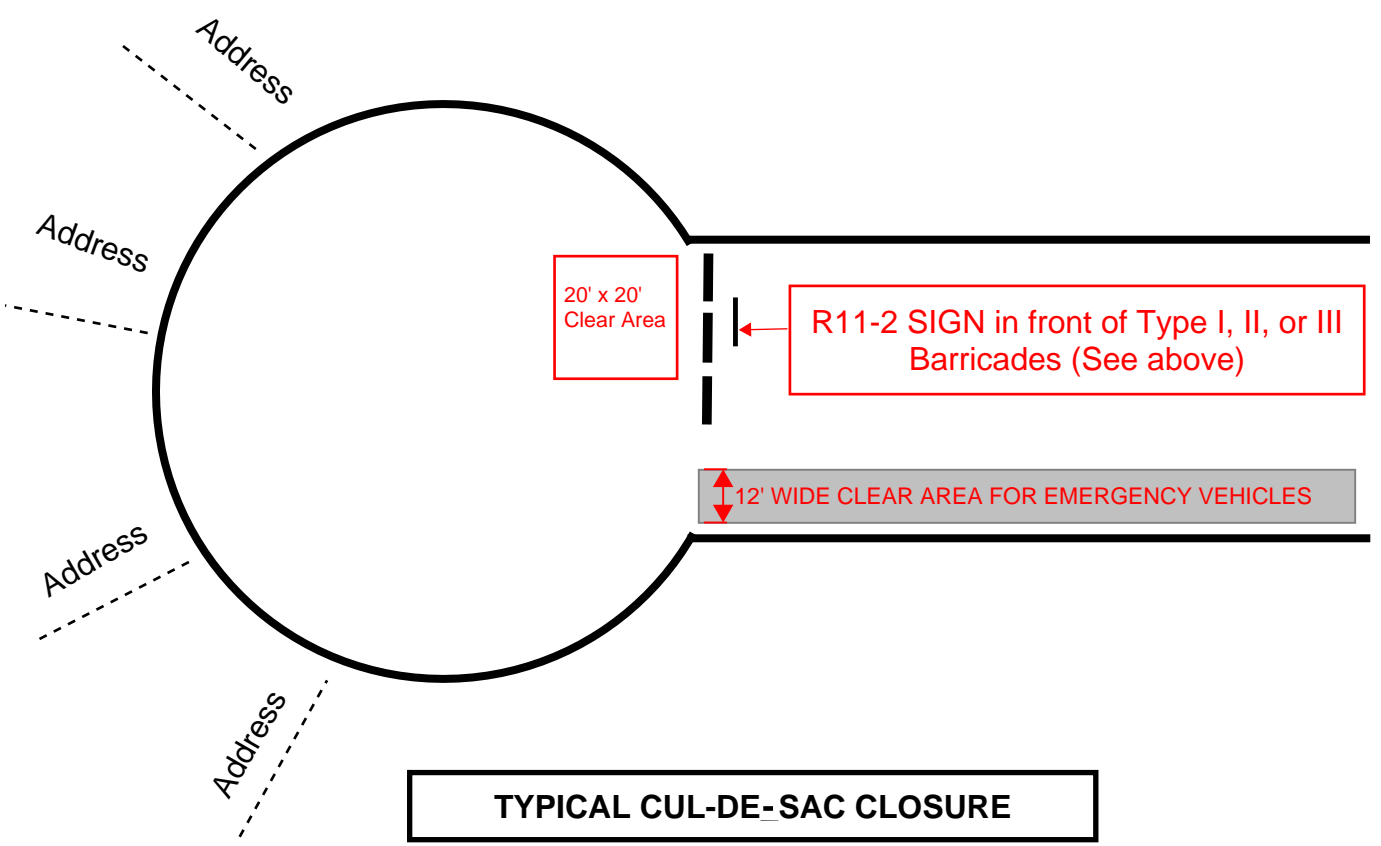

TYPICAL CUL-DE-SAC CLOSURE